

# Total Working Volume = 1000 Litres

x = 1 (Pedestrian Duty)

### Notes:-

1. Standard Minimum Pipework Size Is Ø110mm.
2. This Tank Can Be Installed In Either Granular or Concrete Backfill - Please See Manual For Details.
3. Cover Shown Is Pedestrian Duty.

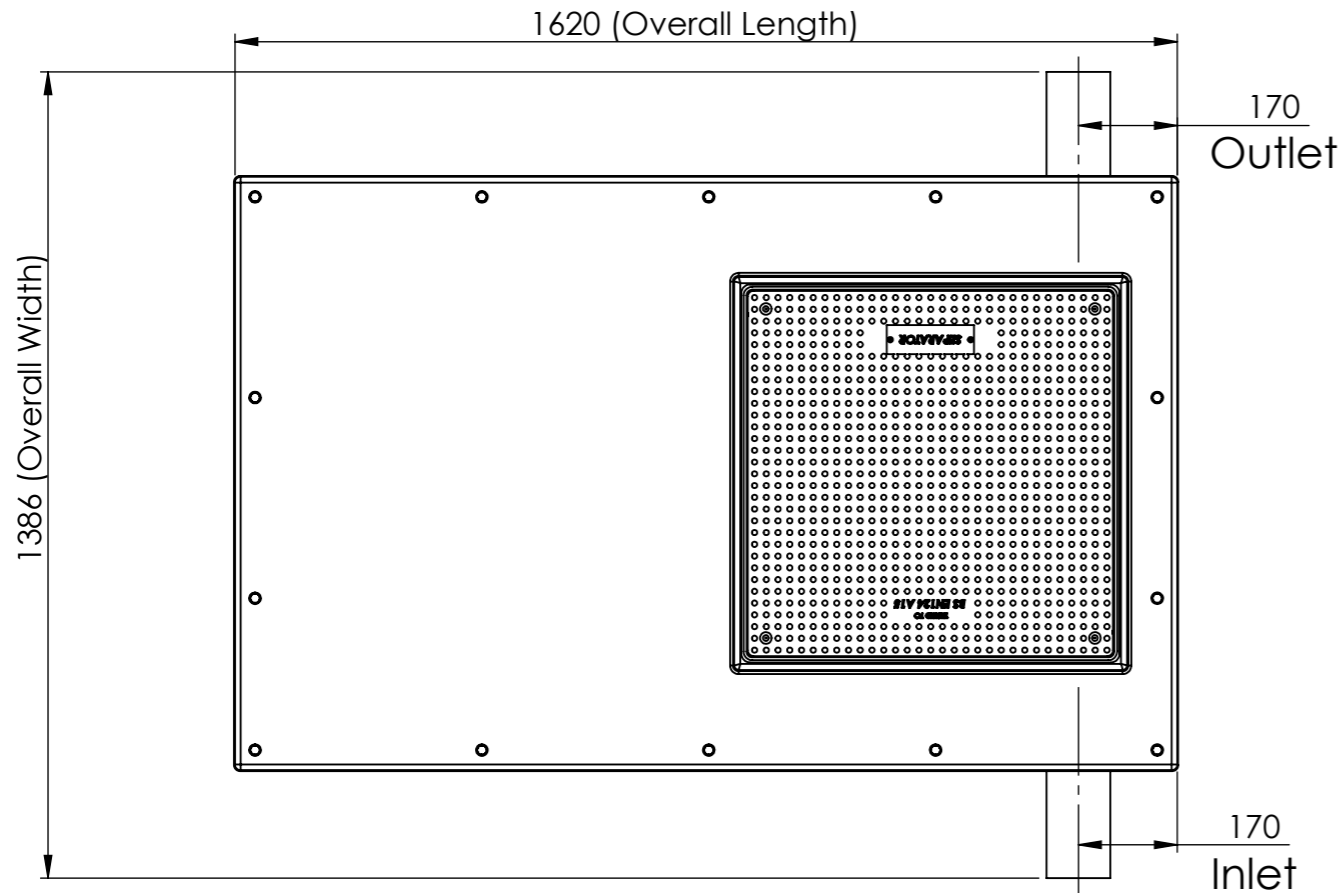
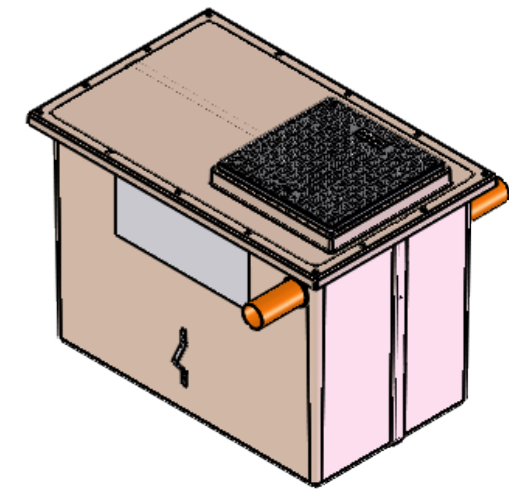

Product	Size
NSG	02

Standard Connection Sizes	
y	Connection (Ø)
A	Ø110

z	Branding
K	Klargester

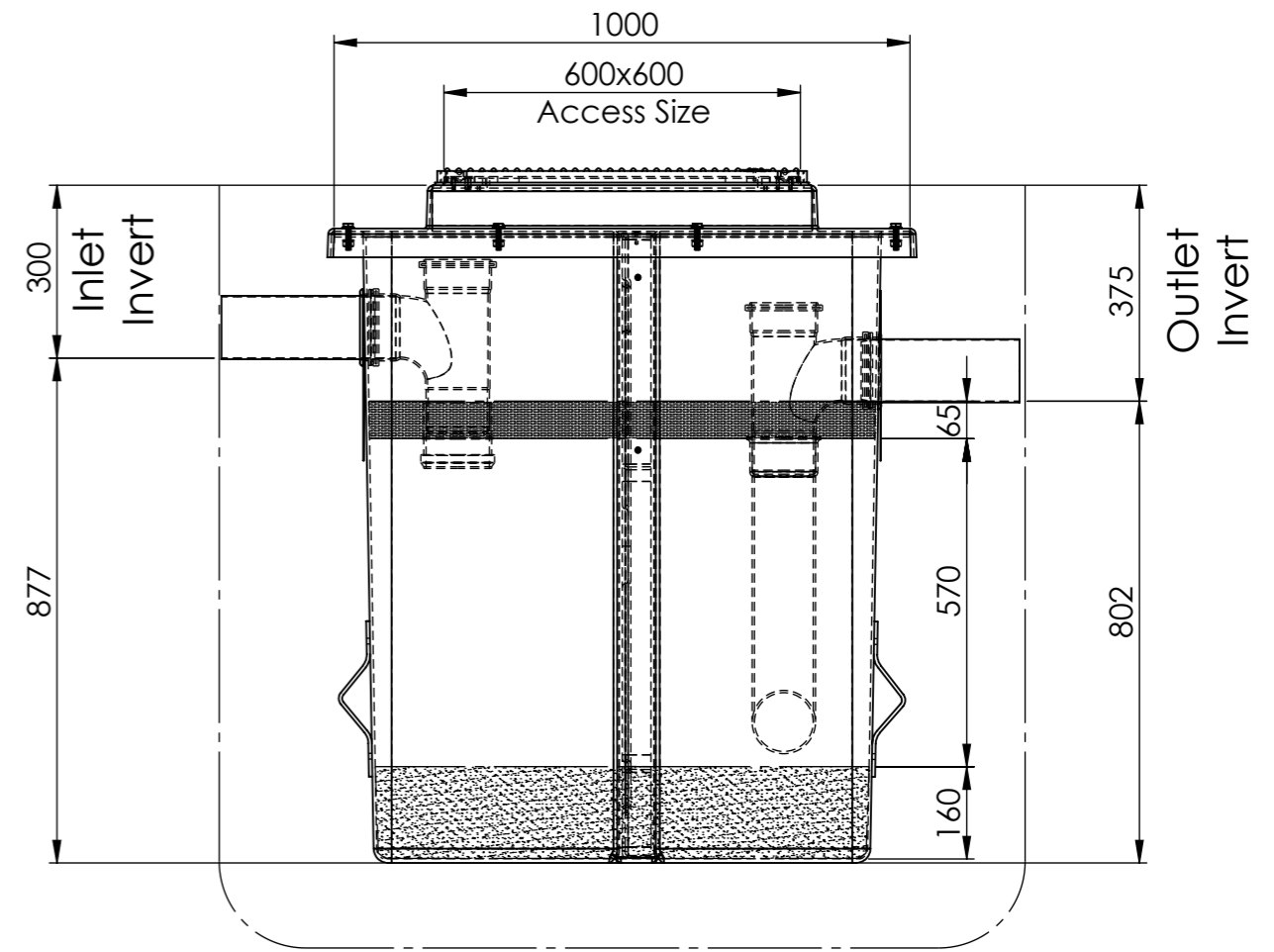
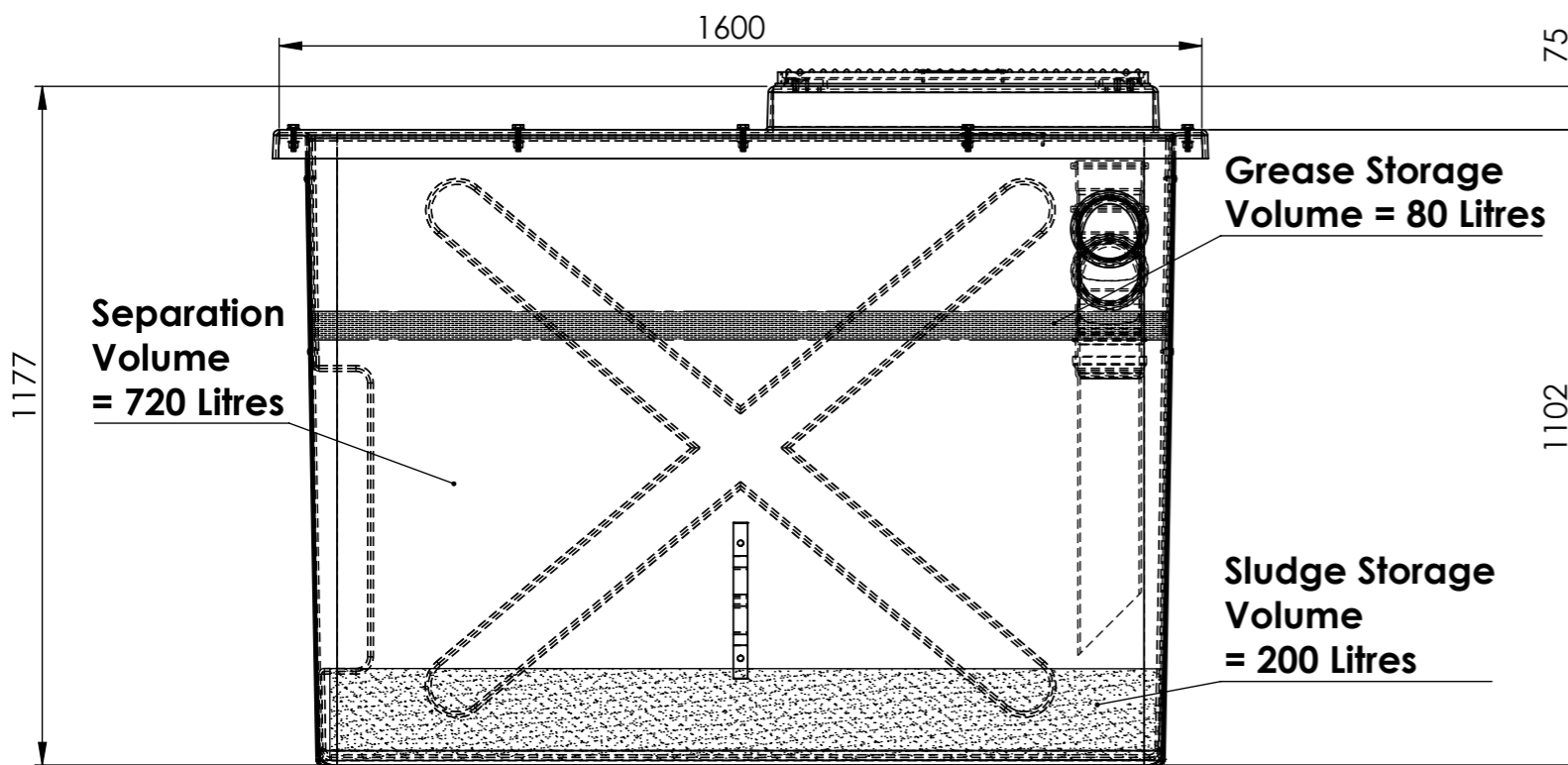

## Cover Loading = EN124 Class A15:- 1.53 Tonne Test Load

Please check with Kingspan Water & Energy for the latest Issue of the drawing

Issue	Date	Drawn By	Approved By	Description
03	19/12/2022	TGY		ECN 1641 - Access Size Added
02	24/08/2016	W.DYER		CC1332

LN Number :	Tolerance (unless stated) :
Finish :	Thickness : n/a
Weight : 99.24 Kg	Surface Area : m <sup>2</sup>
Modelled By : Name	Material : Various

**Drawing : DS1280P** Page 1 of 3  
NSG02 Grease Separator (1000L)

All Dimensions In mm Scale: Do Not Scale

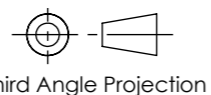

Third Angle Projection

Kingspan Water & Energy reserve the right to alter the details of this drawing without prior notice. This drawing is copyright and may not be reproduced or used without the written permission of Kingspan Water & Energy



x = 2 (Vehicular Duty)

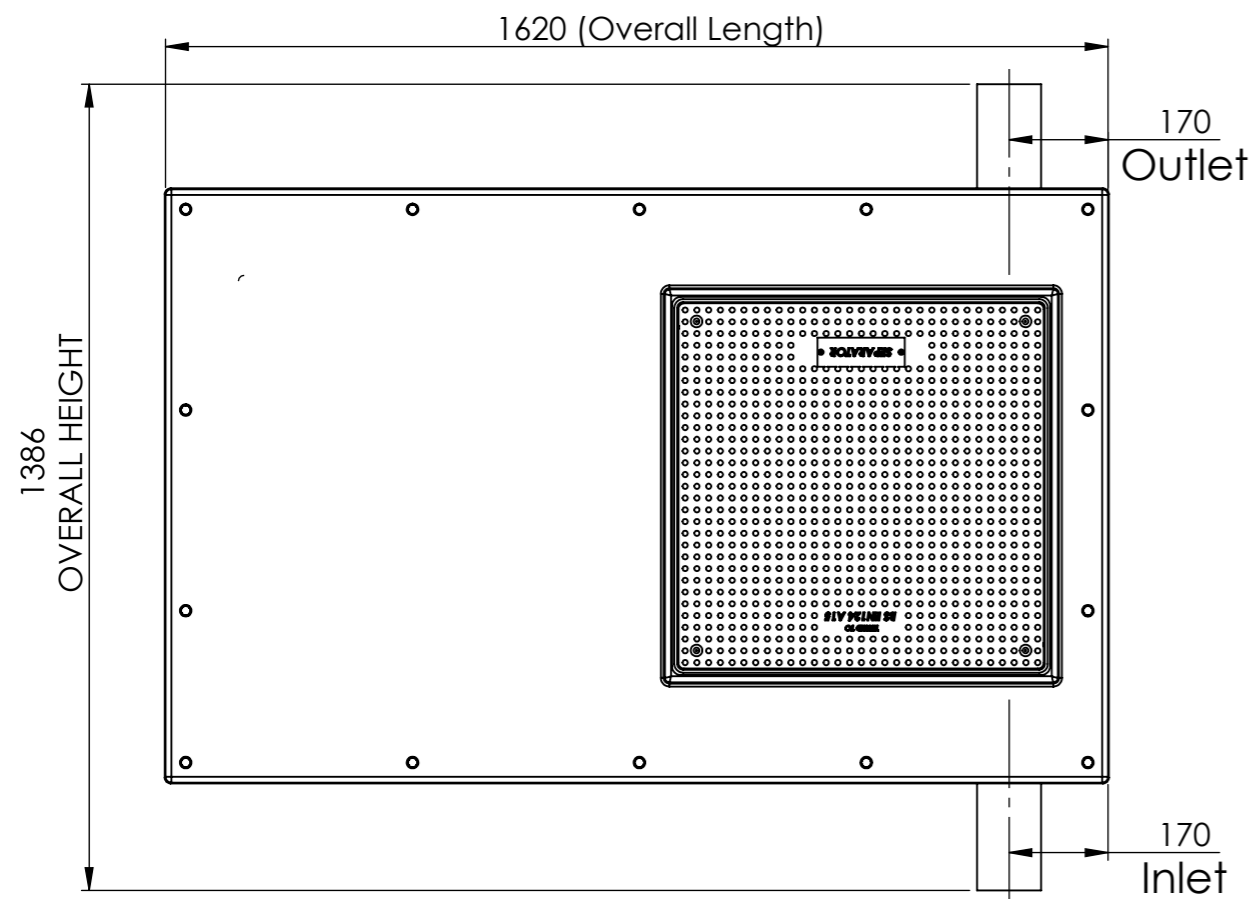

Notes:-

1. Standard Minimum Pipework Size Is  $\varnothing 110\text{mm}$ .
2. This Tank Can Be Installed In **Concrete Backfill Only** - Please See Manual For Details.
3. Cover Shown Is Vehicular Duty.
4. **Cover To Be Supplied Loose With The Unit.**
5. **Vehicular Duty Cover MUST Be Installed Over The Concrete & Not The GRP, Vehicle Load To Be Transferred To The Concrete Surround.**

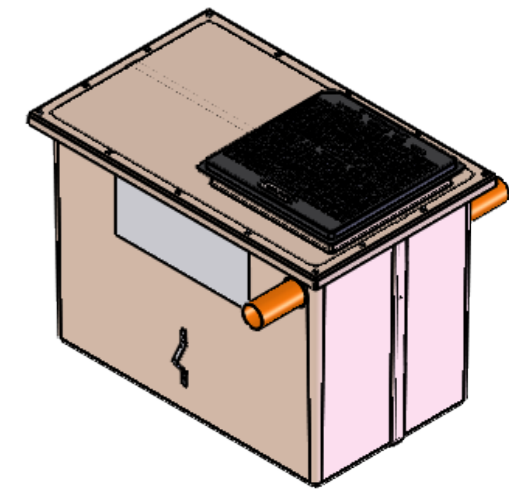

Product	Size
NSG	02

Standard Connection Sizes	
y	Connection ( $\varnothing$ )
A	$\varnothing 110$

z	Branding
K	Klargester

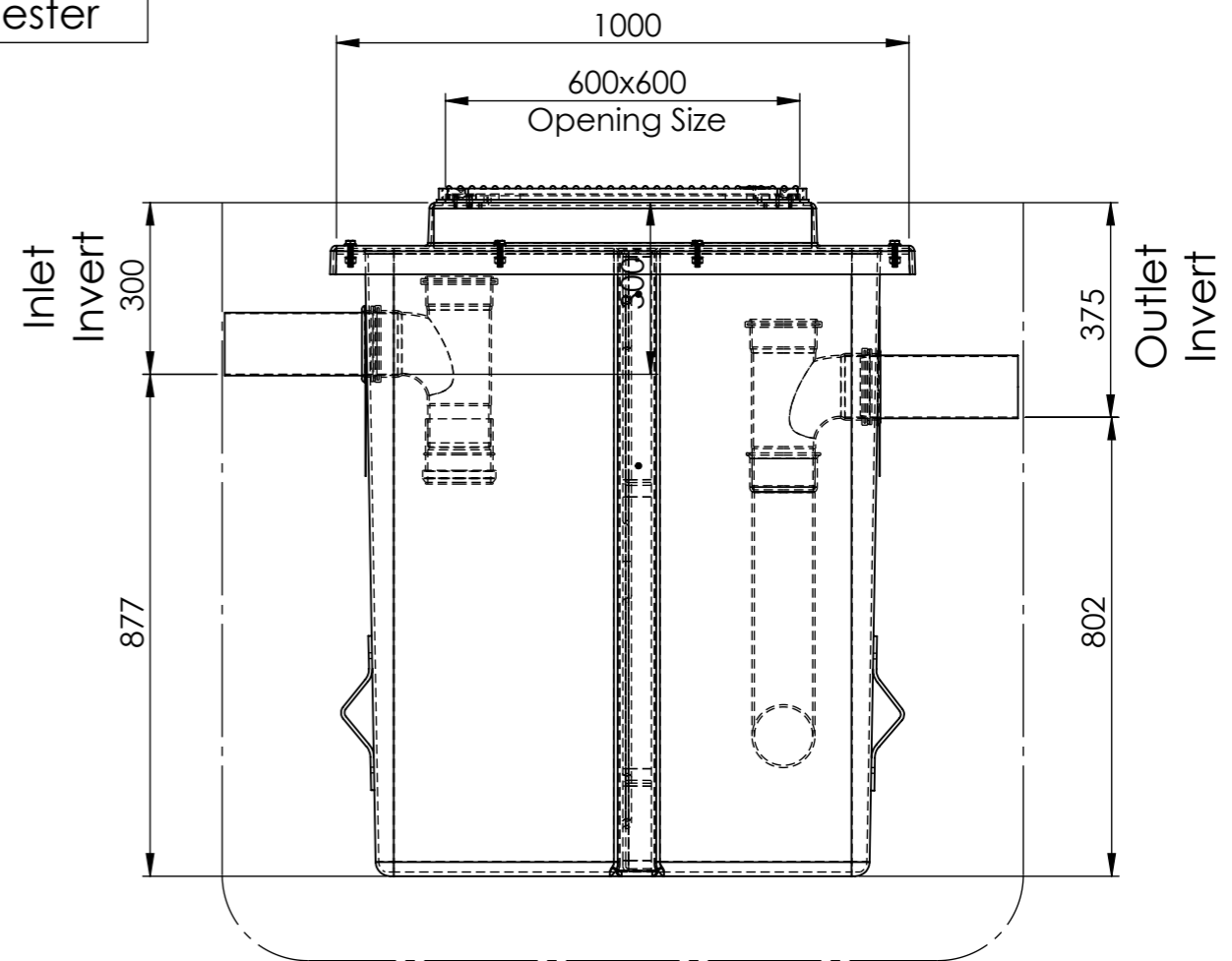
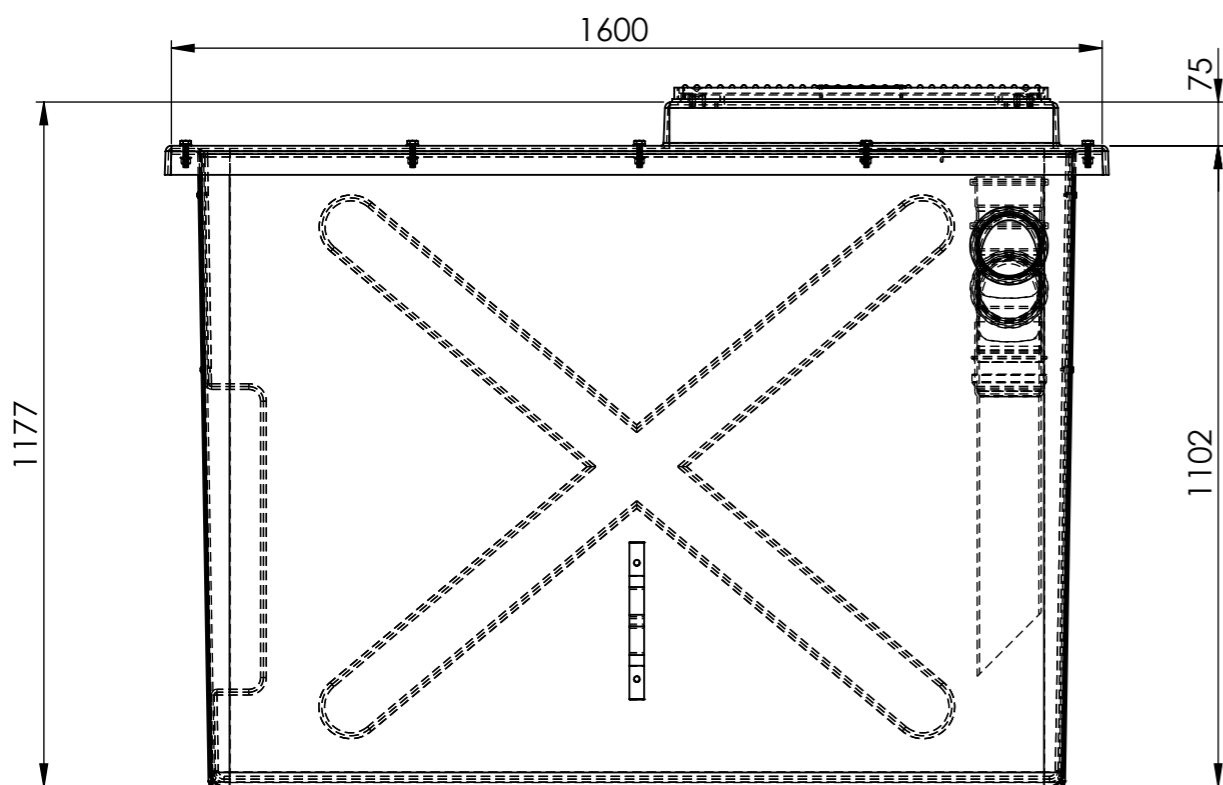

**Cover Loading = EN124 Class B125:- 12.5 Tonne Test Load**

LN Number :	Tolerance (unless stated) :
Finish :	Thickness : n/a
Weight : 99.24 Kg	Surface Area : m <sup>2</sup>
Modelled By : Name	Material : Various

**Drawing : DS1280P**

Page 2 of 3

NSG02 Grease Separator (1000L)

All Dimensions In mm

Scale: Do Not Scale

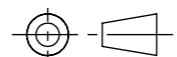

Third Angle Projection

Kingspan Water & Energy reserve the right to alter the details of this drawing without prior notice. This drawing is copyright and may not be reproduced or used without the written permission of Kingspan Water & Energy



# Strapping Details

## Notes:-

1. Holding Down Straps Are Supplied By Others.
2. Use Only One Strap Per Anchor Point.
3. Deadmen Help Anchor Tanks In Installations In Which There Is Potential For A High Water Table Or Trapped Water.

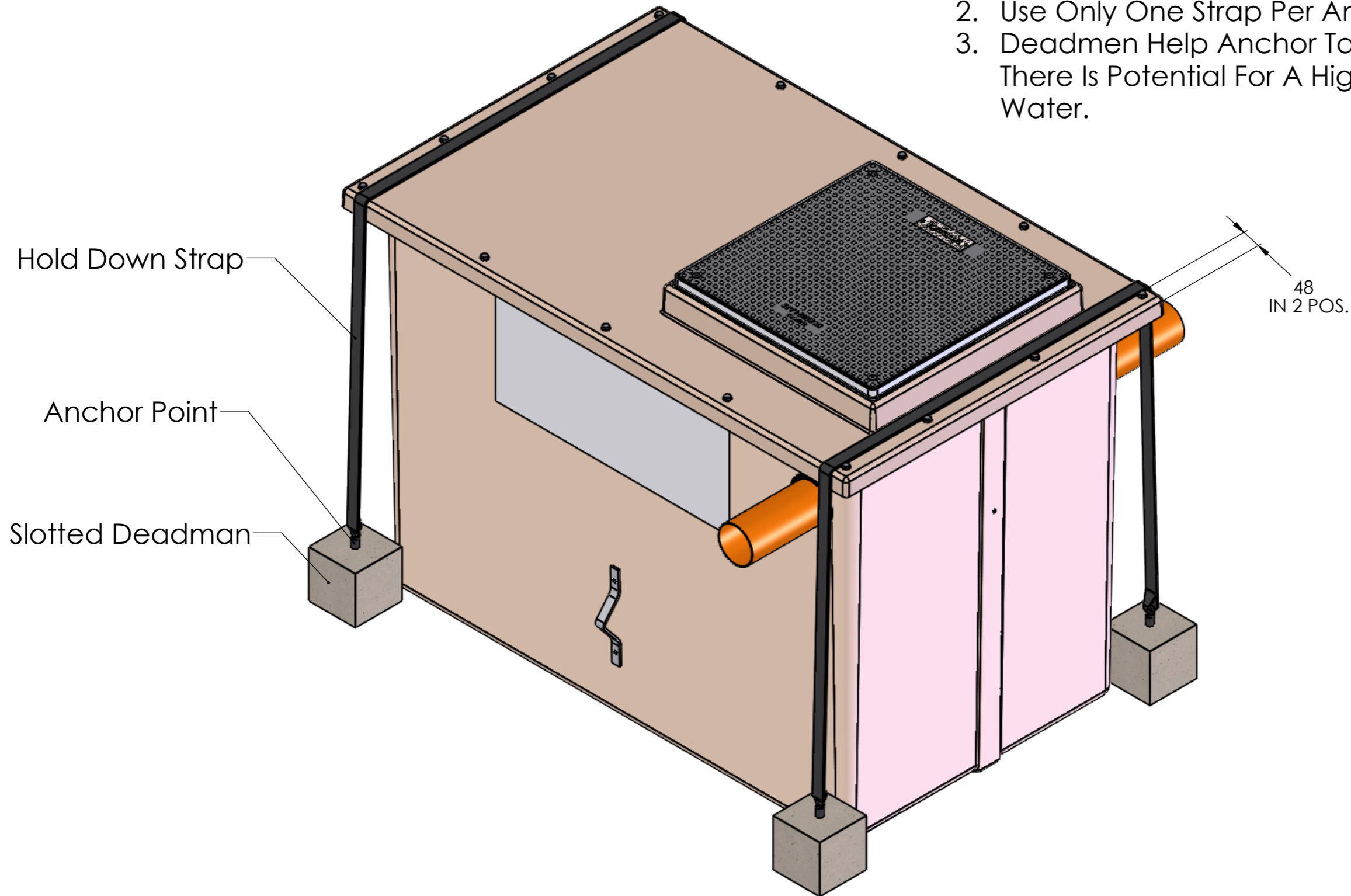

LN Number :	Tolerance (unless stated) :	<b>Drawing : DS1280P</b>	Page 3 of 3
Finish :	Thickness : n/a		
Weight : 99.24 Kg	Surface Area : m <sup>2</sup>	NSG02 Grease Separator (1000L)	
Modelled By : Name	Material : Various		

All Dimensions In mm

Scale: Do Not Scale

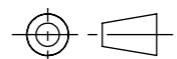

Third Angle Projection

Kingspan Water & Energy reserve the right to alter the details of this drawing without prior notice. This drawing is copyright and may not be reproduced or used without the written permission of Kingspan Water & Energy

